

043-3847 NFB-Y Friction Grip Contra Angle Attachment

OPERATION MANUAL

 : AUTOCLAVABLE
 OM-CK286E 002

! Caution before use

- The Patterson attachment is intended for use by dental professionals only.
- Read this operation manual carefully before using the attachment.
- Be sure to follow all the operating instructions, including all cautions and warnings.
- Keep this Operation Manual for future reference.
- Consider primarily the safety of the patient and the operator when using the attachment.

1. Specifications

HEAD:	043-3847 NFB-Y
Item Number	043-3847 NFB-Y
Applicable Burs	ISO 1.60 FG bur
Installation/removal of bur	Pushbutton type
Allowable max. speed	40,000rpm
Applicable contra angle sheath	043-4126 EC , ISO E-type, 1:1 drive 043-2542 E4R , ISO E-type, 4:1 speed reduction

2. Installation/Removal of Head onto/from Contra Angle Sheath

- Perform installation/removal of head onto/from the E-type contra angle sheath. (Refer to instructions 8: Replacement of Head.)

3. Installation/Removal of FG bur into/from Attachment

- Holding the sheath connected to the head, press the head button with thumb to open the chuck. Then insert an FG bur into the chuck hole. When the end of the FG bur touches the back of the chuck, release the head button.
- Make sure that the FG bur is securely fixed after the installation, pulling it with your fingers.

! Caution

- Never use non-ISO standard, damaged or worn-out FG burs.
- Use clean FG burs. Dirt or debris stuck to the bur shank may clog the chuck mechanism.

4. Operation

- Setting the motor speed below 40,000rpm, perform a test run of the attachment making sure that the FG Bur is securely installed.
- Use the attachment, setting the motor speed appropriately.

! Warning

- When abnormal vibration, noise, overheating, etc., occurs while the attachment is in the test run or in use, stop using the attachment immediately. **In such a case, consult the Patterson Service Center.**
- Never press pushbutton when the motor is rotating.
- Never connect/disconnect the attachment when the motor is rotating.
- Never set motor speed above 40,000rpm.

5. Cleaning and Drying

The attachment must be cleaned and lubricated after each use and before each autoclaving, using 5: Cleaning and Drying and 6: Cleaning and Lubrication.

Cleaning and Drying the Exterior

The use of automated cleaning devices is not recommended for the cleaning of the Friction Grip Contra Angle Attachment.

Wash the handpiece under running water following the procedures below. (Water condition: $\leq 100^{\circ}\text{F}$, $\geq 3.5\text{L}/\text{min}$; water should be of the same quality as drinking water)

- Clean the external surfaces of the handpiece with a soft bristled toothbrush for 15 seconds or more.
- Clean around the bur insertion hole for 15 seconds or more, using an interdental brush (wire thickness 0.7mm) that conforms to size 4 in ISO 16409.

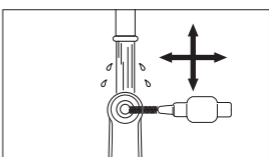
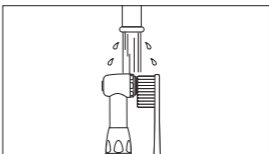

Under appropriate lighting (natural office lighting, 500 lx or higher), inspect the handpiece for blood or other debris. If any visible debris remains, repeat the process until the handpiece is visually clean.

After cleaning, if the residual moisture is present, wipe off with dry cloth or blow it off with compressed air ($\leq 50.75\text{psi}$) until there is no moisture in the interior and exterior.

When blowing off with compressed air, cover the handpiece with cloth to prevent scattering of water. Proceed to 6: Cleaning and Lubrication.

6. Cleaning and Lubrication

Cleaning and Lubricating the Interior

- Attach an E-Type spray nozzle to the nozzle of the PANA SPRAY Plus.
- Shake the can 3 or 4 times and insert the E-Type spray nozzle into the rear of the handpiece while holding the head of the handpiece with a cloth etc.
- Hold the handpiece and spray for 2 or 3 seconds until oil comes out of the handpiece head. Repeat lubrication until foreign material stops coming out of the tip.

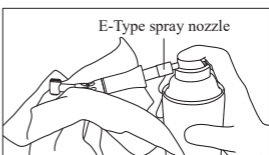



Caution

- Do not use sprays other than PANA SPRAY Plus. Using sprays other than PANA SPRAY Plus may cause the handpiece to overheat.
- Hold the spray can upright.
- Firmly hold the handpiece to prevent it slipping when spray pressure is applied.
- Spray lubricant until it expels from the handpiece head.
- If you wish to purge excessive oil from inside the handpiece, rotate the handpiece for approx 15 seconds without a bur. During the rotation, do not depress the push button, especially when using absorbent cloth to prevent oil from scattering. Depressing the push button during rotation may damage the chuck mechanism.

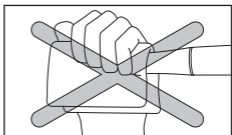
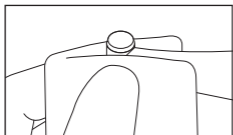

7. Sterilization

Autoclaving is recommended for sterilization.

- Before sterilization, clean the surface of the attachment and lubricate the attachment (refer to instructions 5: Cleaning and Drying and 6: Cleaning and Lubrication.).
- Put the attachment into a sterilization pouch by itself.
- Place the attachment in the center or upper shelf of the autoclave chamber.
- Autoclave the handpiece at **275°F** for 20 minutes.



Caution

- Never use dry heat sterilization, cold sterilization, etc.
- Never autoclave the attachment with other instruments in the same sterilization pouch.
- Never place the attachment at the bottom of the autoclave chamber, as the temperature at the bottom may rise above the actual setting temperature.

8. Replacement of Head

The replacement head is supplied with a transmission gear.

- Remove the head from the sheath with your fingers, turning the union nut clockwise. Pull the transmission gear out from the head.
- Insert the gear supplied with the replacement head into the sheath, aligning the clutch of the head with that of the sheath. Then install the head onto the sheath, turning the union nut counterclockwise with your fingers.

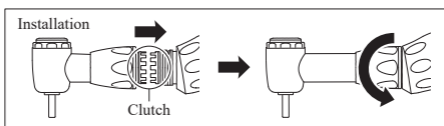
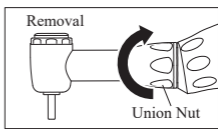

9. Replacement of Cartridge

- Pull the transmission gear out from the head.
- Remove the head cap using the wrench.
- Push the used-up cartridge out from the head using a pin or driver.
- Insert the new cartridge into the head, aligning the knob of the cartridge with the slit inside the head.
- Fix the head cap.
- Insert the transmission gear into the head, then rotate it manually with your fingers so that the transmission gear engages with the gear inside the head.
- Lubricate the attachment, then perform a trial run.

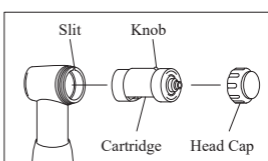
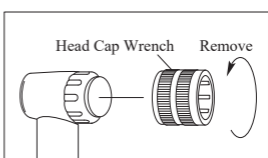

10. Guarantee

Patterson guarantees the head for six months and the sheath for 10 months subject to observance of maintenance instructions, cautions, warnings and normal use.

Note

- Patterson reserves the right to analyze and determine the cause of any failure.
- Guarantee is void if the breakage, accident or any other issues are caused by the neglect of daily maintenance, cautions, warnings or common sense in use.
- Dismantling or reassembling by any third party other than the Patterson Service Center, except the replacement of the head and the disassembling instructions for lubrication, voids guarantee.

11. Symbol



This product can be sterilized in a steam sterilizer at 135°C.



HIBCC DataMatrix for Unique Device Identifier.

Pour une version en français du manuel d'utilisation, veuillez vous rendre sur le site Web de Patterson:

<https://www.pattersondental.com/fr-CA>

Manufactured for:

Fabriqué pour :

Patterson Dental Supply, Inc.
1031 Mendota Heights Road
Saint Paul, MN 55120

2022-11-21 CACCXXXX XXXN